

SL POWER KT1001 & KT1002

Blade Kit for SLE Product Families



Advanced Energy's SL Power KT1001 series and KT1002 series are suitable for SLE product family, KT1001XX and KT1002XX blade kits are available for specific product series.

AT A GLANCE

KT1001XX Suitable Power Supply

SLE06

SLE12

SLE18

SLE24

SLE36N

SLE60

KT1002XX Suitable Power Supply

SLE33

SLE36X

SPECIAL FEATURES

- Wall Mount
- Interchangeable
- Universal input compatibility
- Hassle free of carrying
- KT1002XX is IP42 compliance
- RoHS and REACH compliance

Note: Consult Factory for compliance information.

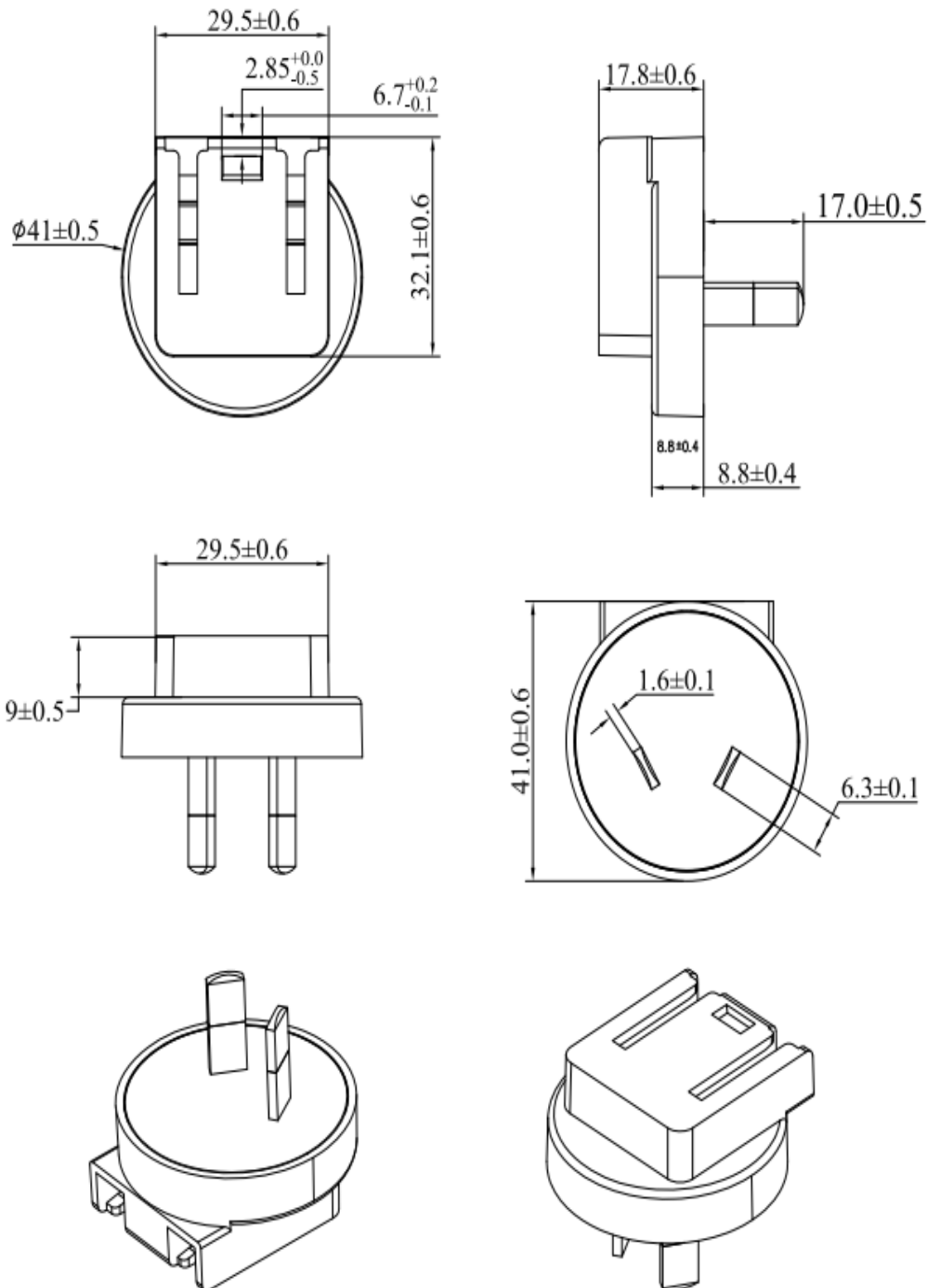

KT1001AU

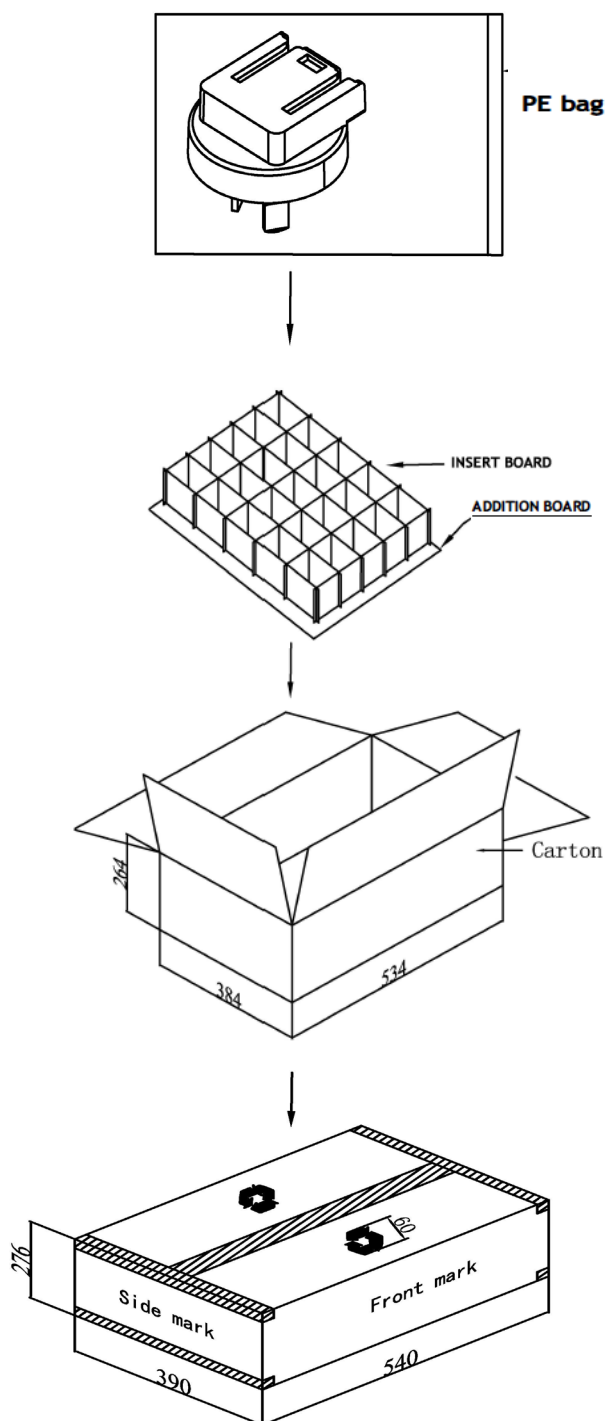

Technical Requirement:

1. Carton: 2 layers wall, 6mm thickness.
Outline dimension: 540mm x 390mm x 276mm
2. Additional board:
3 mm thickness
3 pieces per carton.
3. Humidity protector:
Each plug packed in a small PE bag.
All plugs packed in a big PE bag with an outer carton.
4. Quantity:
2 layers per carton.
200 pes. per layer.
400 pes. per carton.
5. Weight:
Each carton approx. 8.6 kg gross.
Each carton approx. 6.4 kg net.

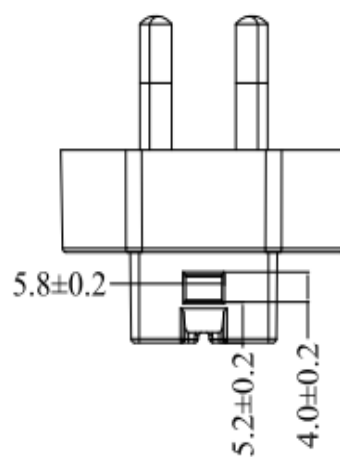
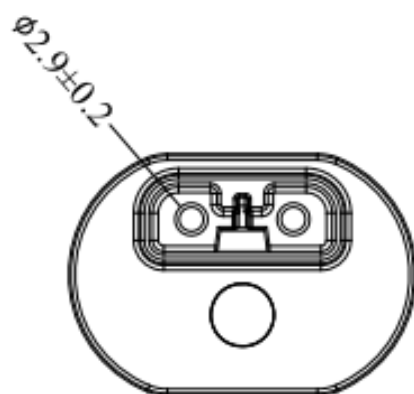
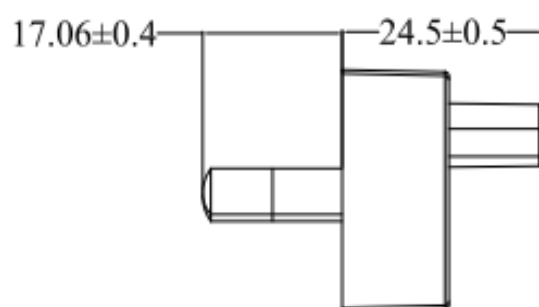
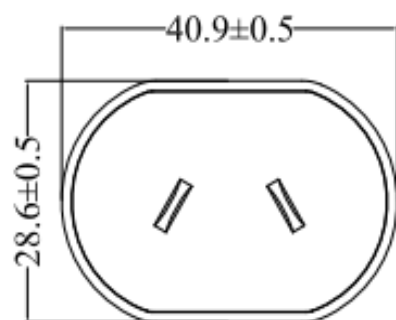

KT1002AU

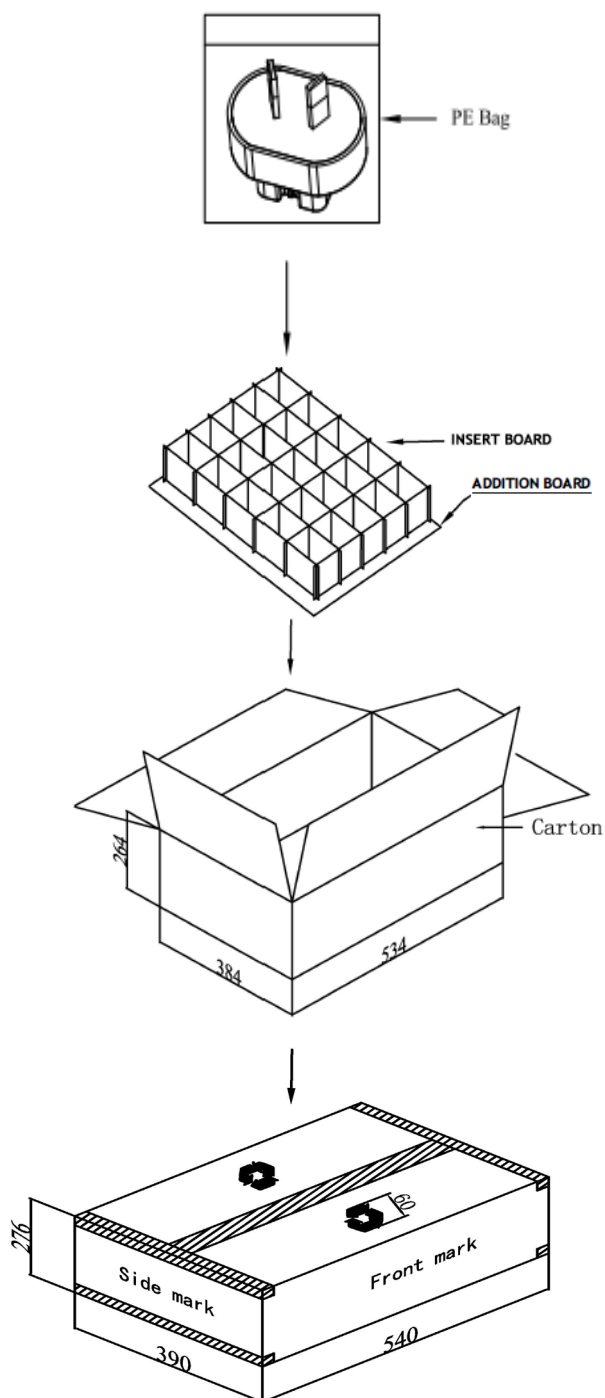

Technical Requirement:

1. Carton: 2 layers wall, 6mm thickness.
Outline dimension: 540mm x 390mm x 276mm
2. Additional board:
3 mm thickness
3 pieces per carton.
3. Humidity protector:
Each plug packed in a small PE bag.
All plugs packed in a big PE bag with an outer carton.
4. Quantity:
2 layers per carton.
200 pes. per layer.
400 pes. per carton.
5. Weight:
Each carton approx. 7.8 kg gross.
Each carton approx. 5.8 kg net.

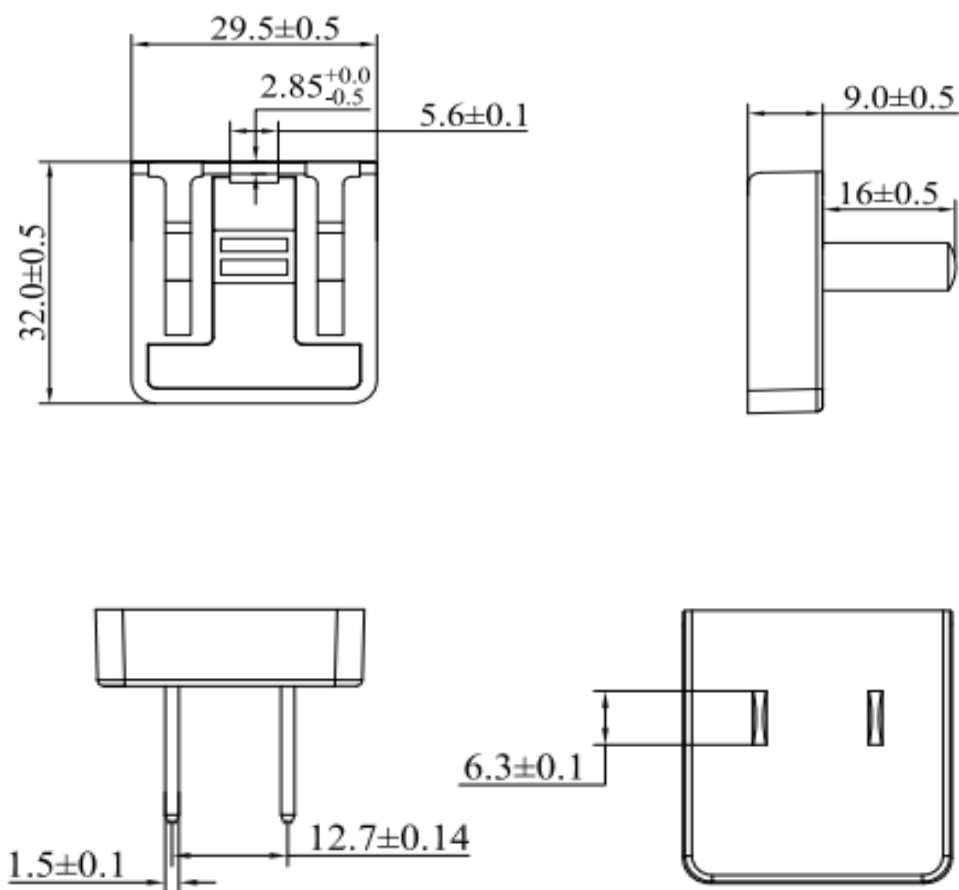

KT1001CH

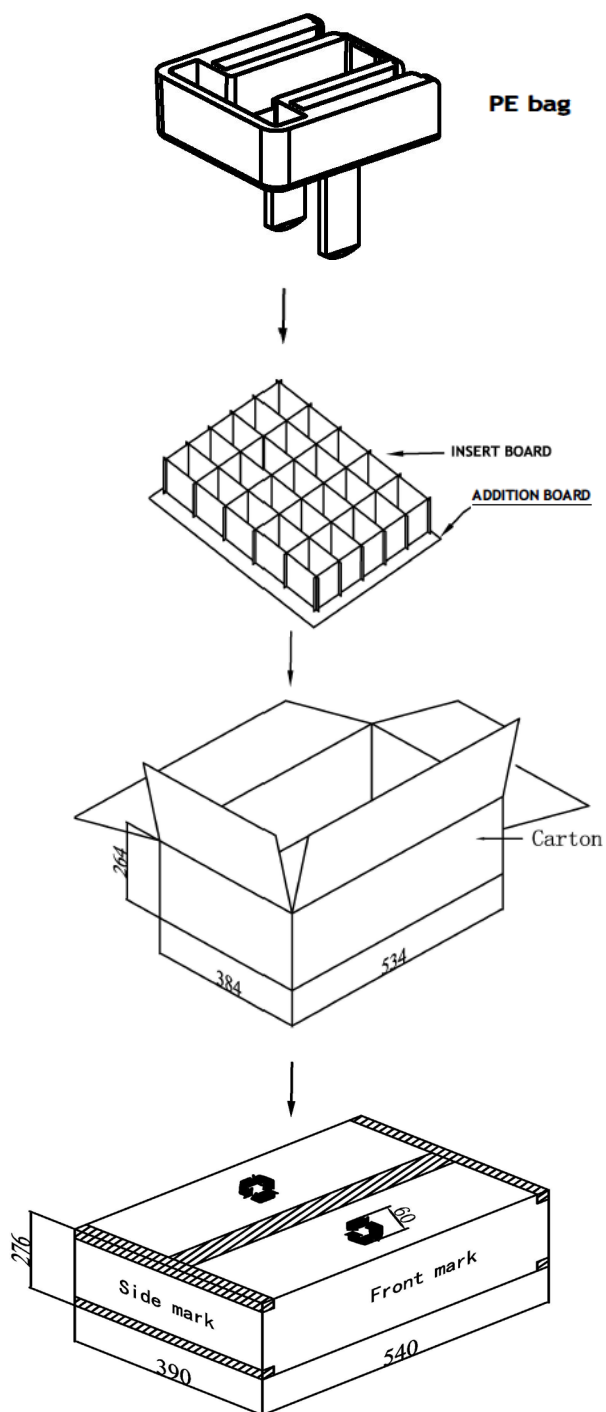

Technical Requirement:

1. Carton: 2 layers wall, 6mm thickness.
Outline dimension: 540mm x 390mm x 276mm
2. Additional board:
3 mm thickness
3 pieces per carton.
3. Humidity protector:
Each plug packed in a small PE bag.
All plugs packed in a big PE bag with an outer carton.
4. Quantity:
2 layers per carton.
200 pes. per layer.
400 pes. per carton.
5. Weight:
Each carton approx. 5.6 kg gross.
Each carton approx. 3.4 kg net.

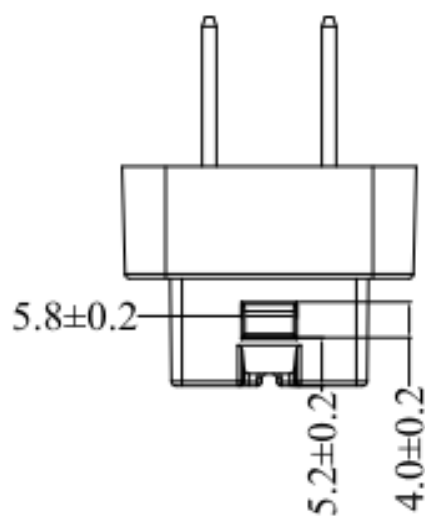
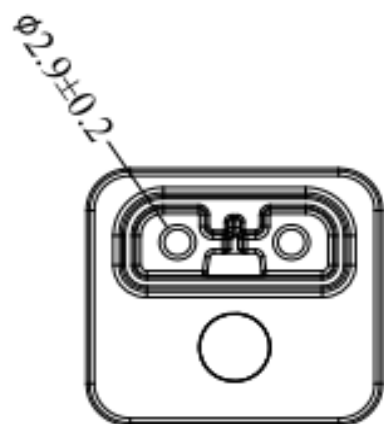
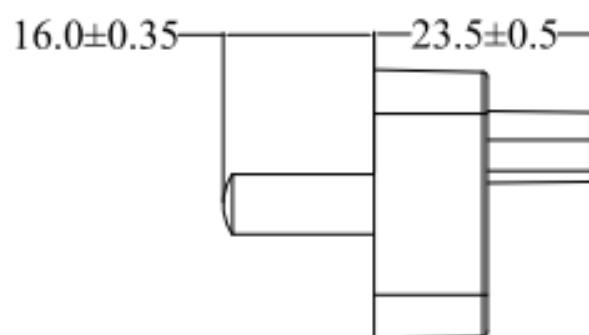
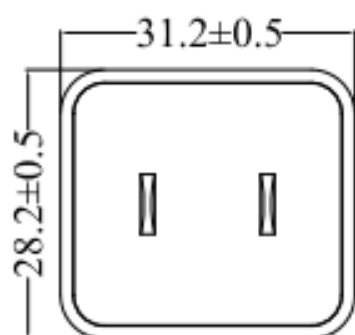

KT1002CH

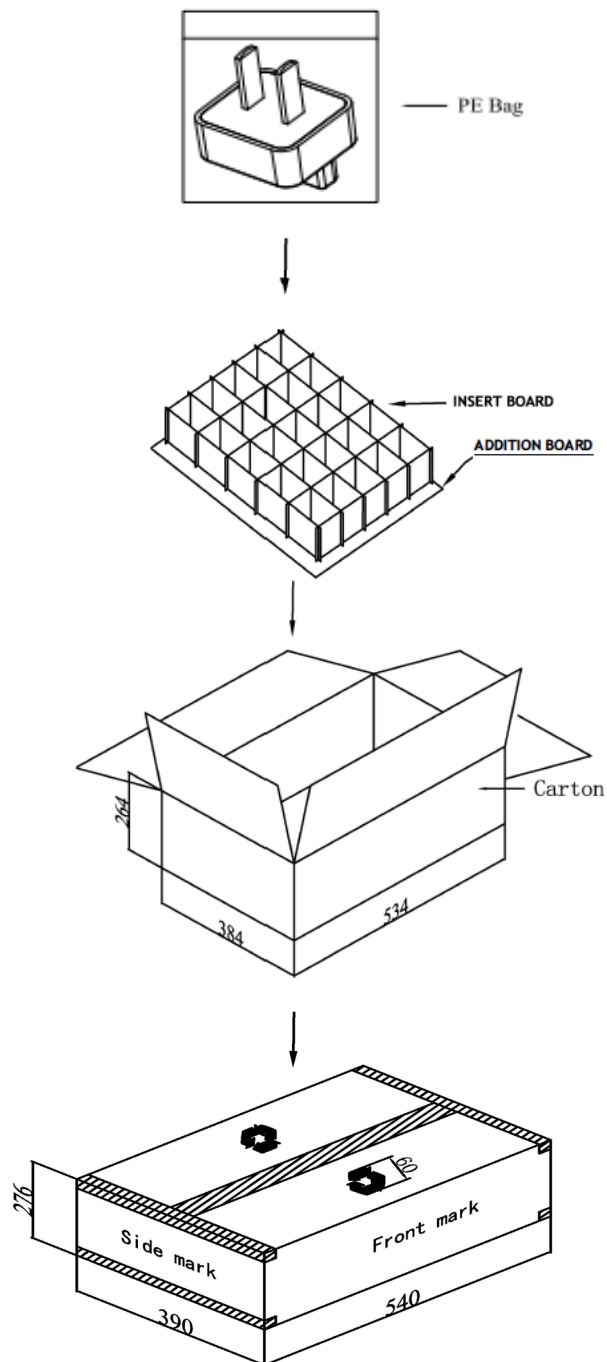

Technical Requirement:

1. Carton: 2 layers wall, 6mm thickness.
Outline dimension: 540mm x 390mm x 276mm
2. Additional board:
3 mm thickness
3 pieces per carton.
3. Humidity protector:
Each plug packed in a small PE bag.
All plugs packed in a big PE bag with an outer carton.
4. Quantity:
2 layers per carton.
200 pes. per layer.
400 pes. per carton.
5. Weight:
Each carton approx. 7.2 kg gross.
Each carton approx. 5.2 kg net.

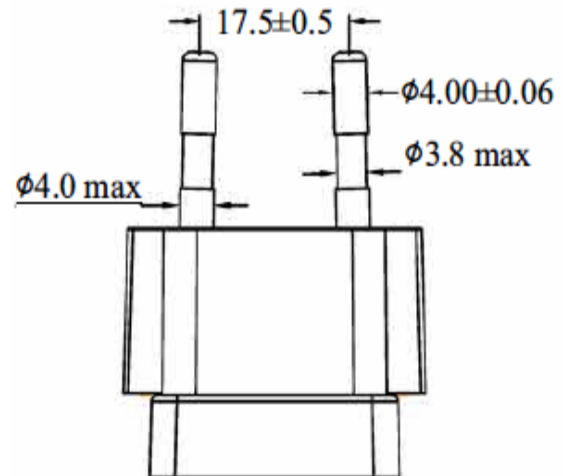
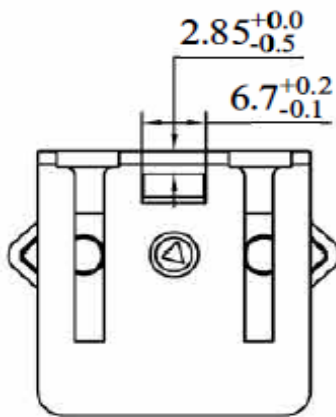
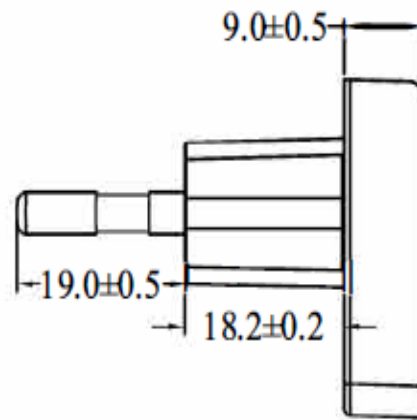
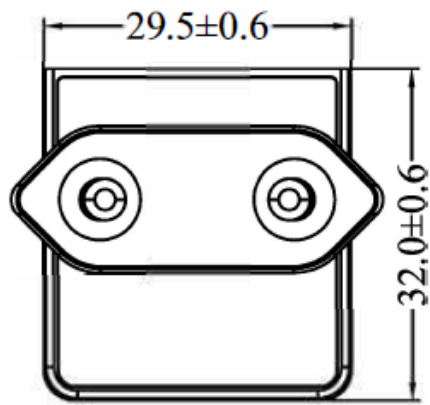

KT1001EU

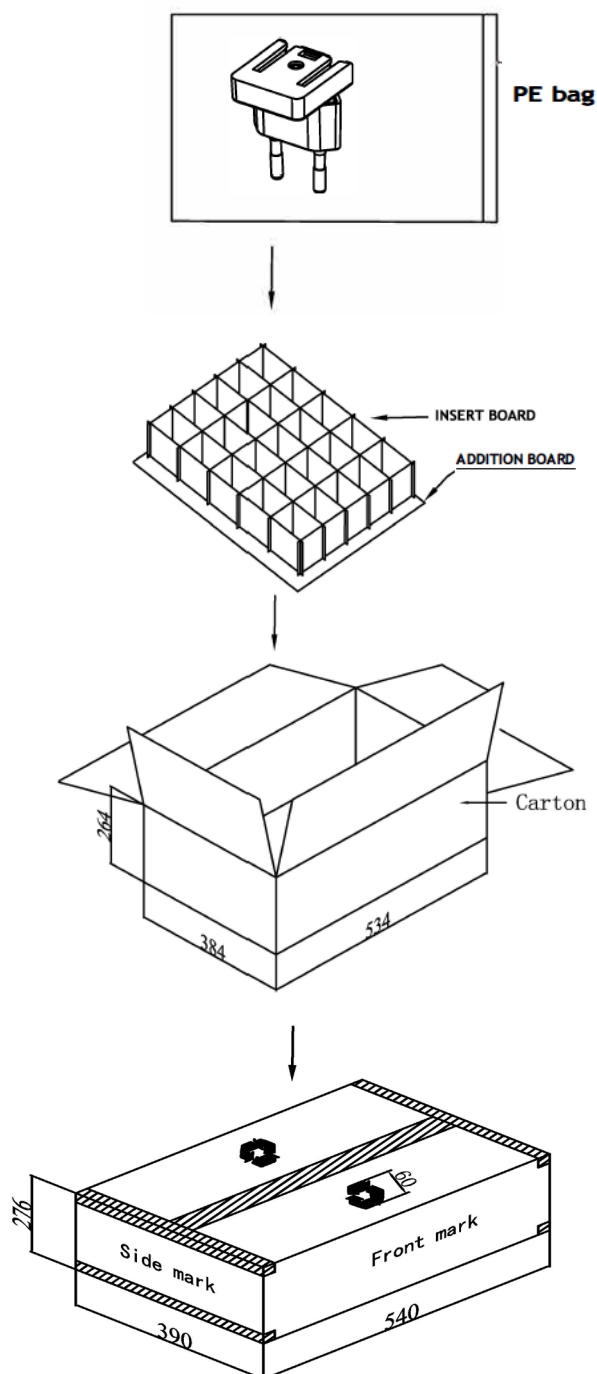

Technical Requirement:

1. Carton: 2 layers wall, 6mm thickness.
Outline dimension: 540mm x 390mm x 276mm
2. Additional board:
3 mm thickness
3 pieces per carton.
3. Humidity protector:
Each plug packed in a small PE bag.
All plugs packed in a big PE bag with an outer carton.
4. Quantity:
2 layers per carton.
200 pes. per layer.
400 pes. per carton.
5. Weight:
Each carton approx. 9.4 kg gross.
Each carton approx. 7.2 kg net.

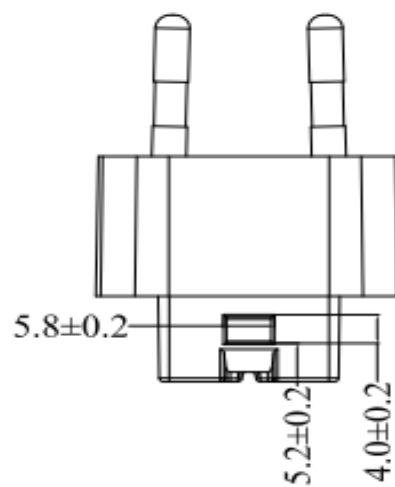
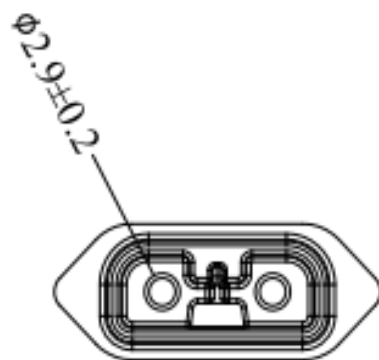
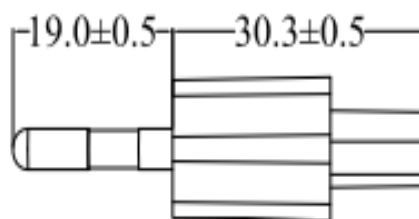
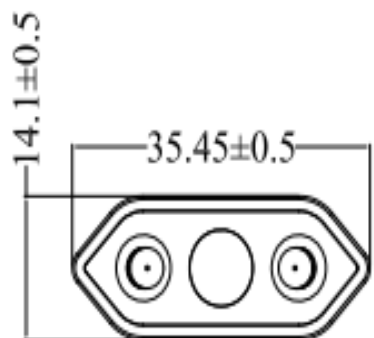

KT1002EU

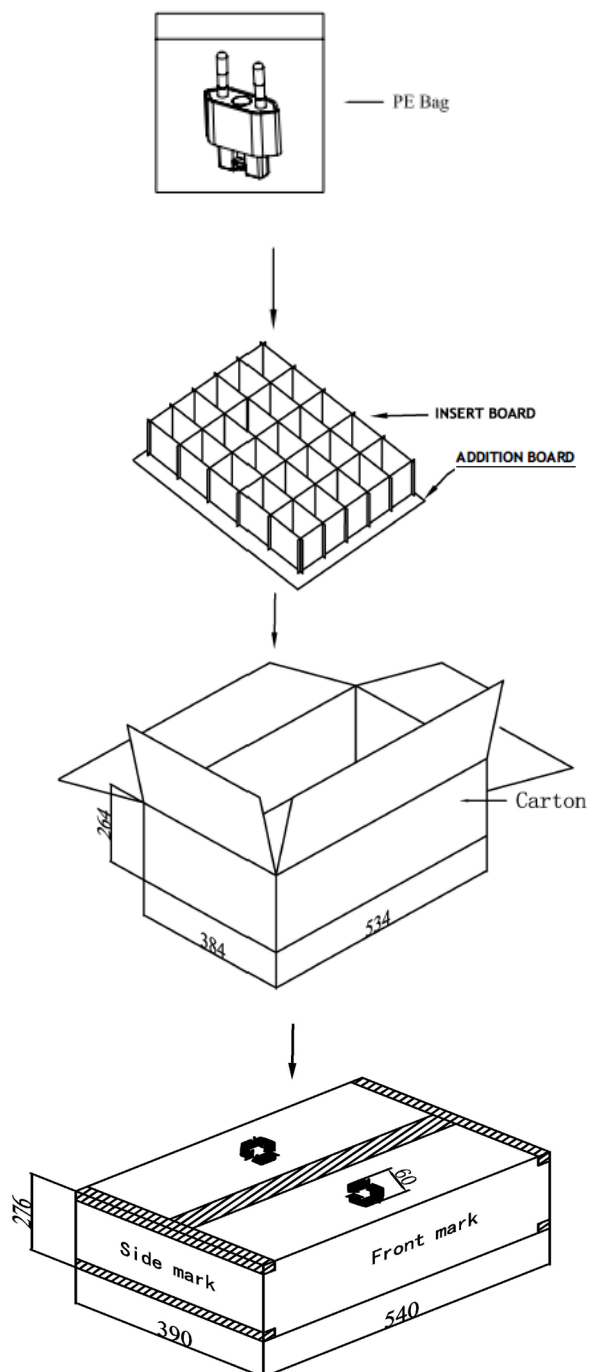

Technical Requirement:

1. Carton: 2 layers wall, 6mm thickness.
Outline dimension: 540mm x 390mm x 276mm
2. Additional board:
3 mm thickness
3 pieces per carton.
3. Humidity protector:
Each plug packed in a small PE bag.
All plugs packed in a big PE bag with an outer carton.
4. Quantity:
2 layers per carton.
200 pes. per layer.
400 pes. per carton.
5. Weight:
Each carton approx. 7.4 kg gross.
Each carton approx. 5.4 kg net.

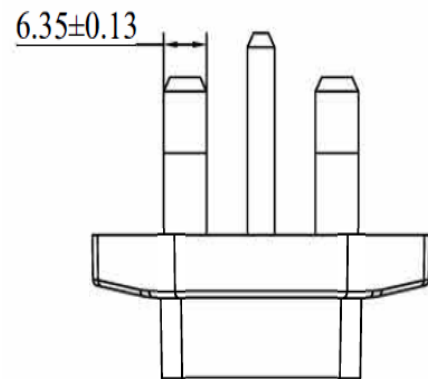
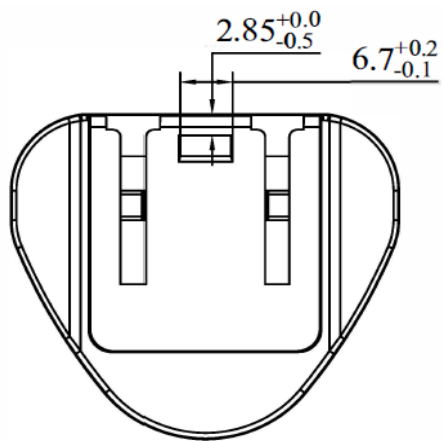
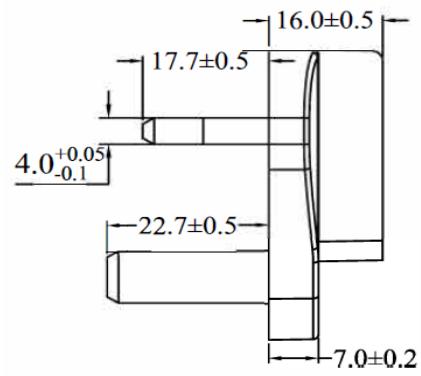
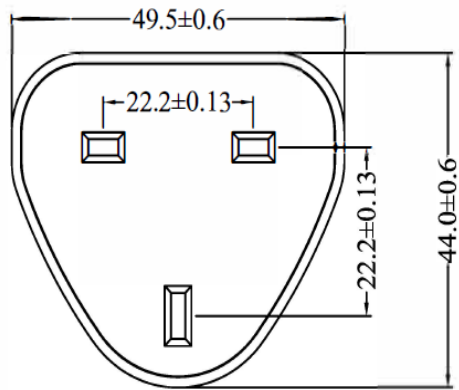

KT1001UK

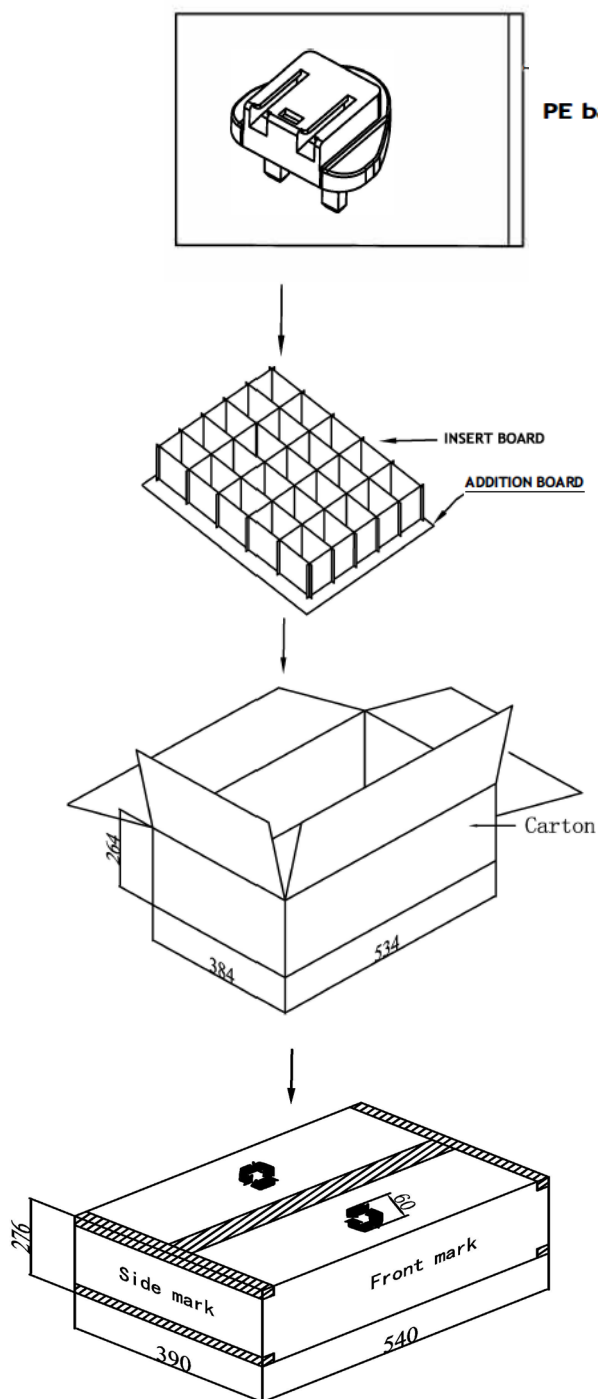

Technical Requirement:

1. Carton: 2 layers wall, 6mm thickness.
Outline dimension: 540mm x 390mm x 276mm
2. Additional board:
3 mm thickness
3 pieces per carton.
3. Humidity protector:
Each plug packed in a small PE bag.
All plugs packed in a big PE bag with an outer carton.
4. Quantity:
2 layers per carton.
200 pes. per layer.
400 pes. per carton.
5. Weight:
Each carton approx. 11.4 kg gross.
Each carton approx. 9.2 kg net.

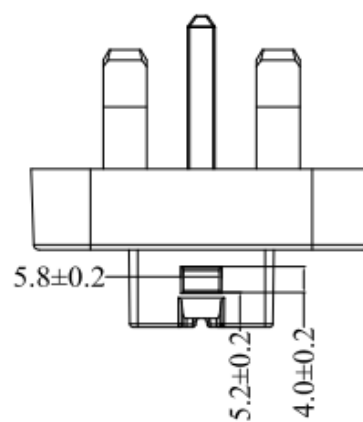
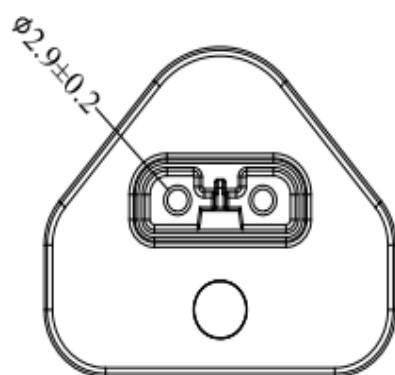
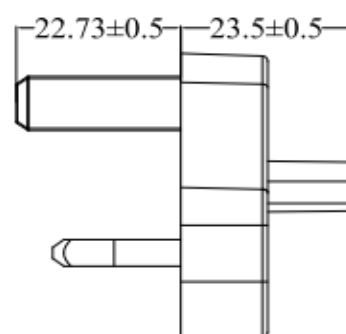
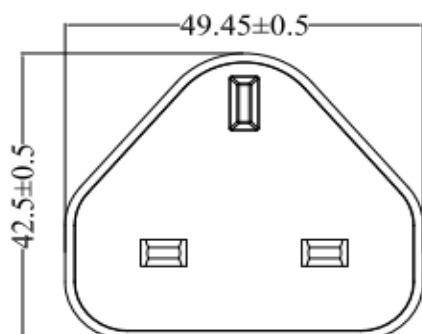

KT1002UK

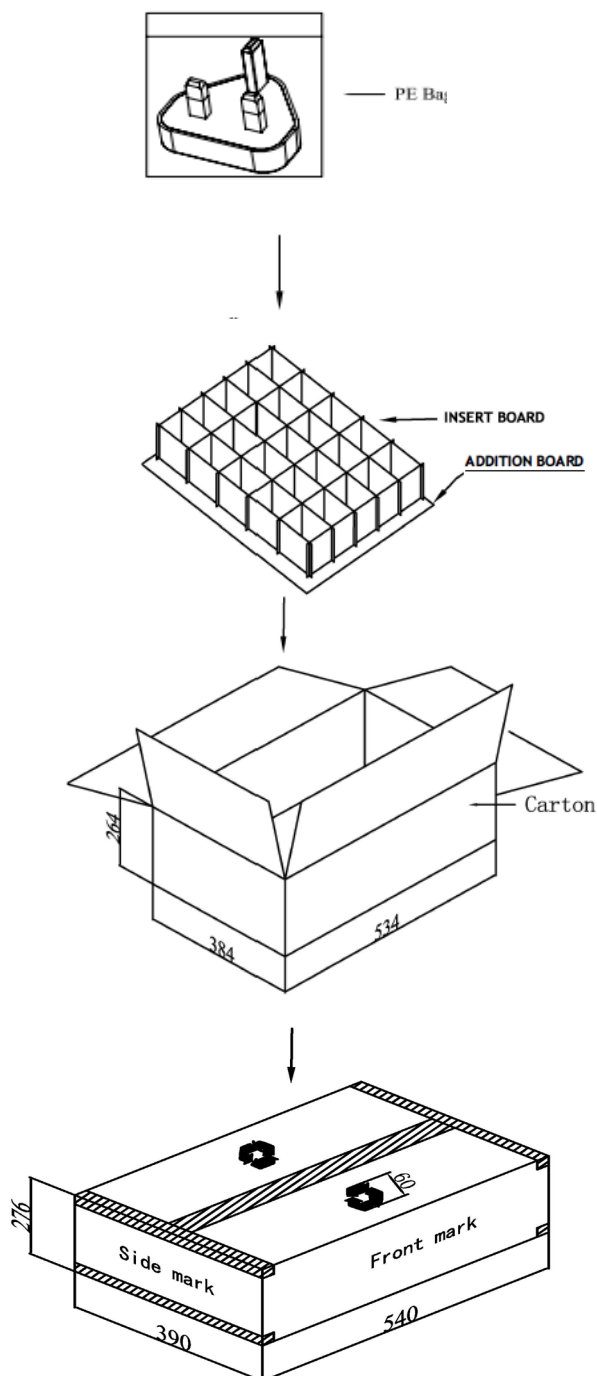

Technical Requirement:

1. Carton: 2 layers wall, 6mm thickness.
Outline dimension: 540mm x 390mm x 276mm
2. Additional board:
3 mm thickness
3 pieces per carton.
3. Humidity protector:
Each plug packed in a small PE bag.
All plugs packed in a big PE bag with an outer carton.
4. Quantity:
2 layers per carton.
200 pes. per layer.
400 pes. per carton.
5. Weight:
Each carton approx. 11.6 kg gross.
Each carton approx. 9.6 kg net.

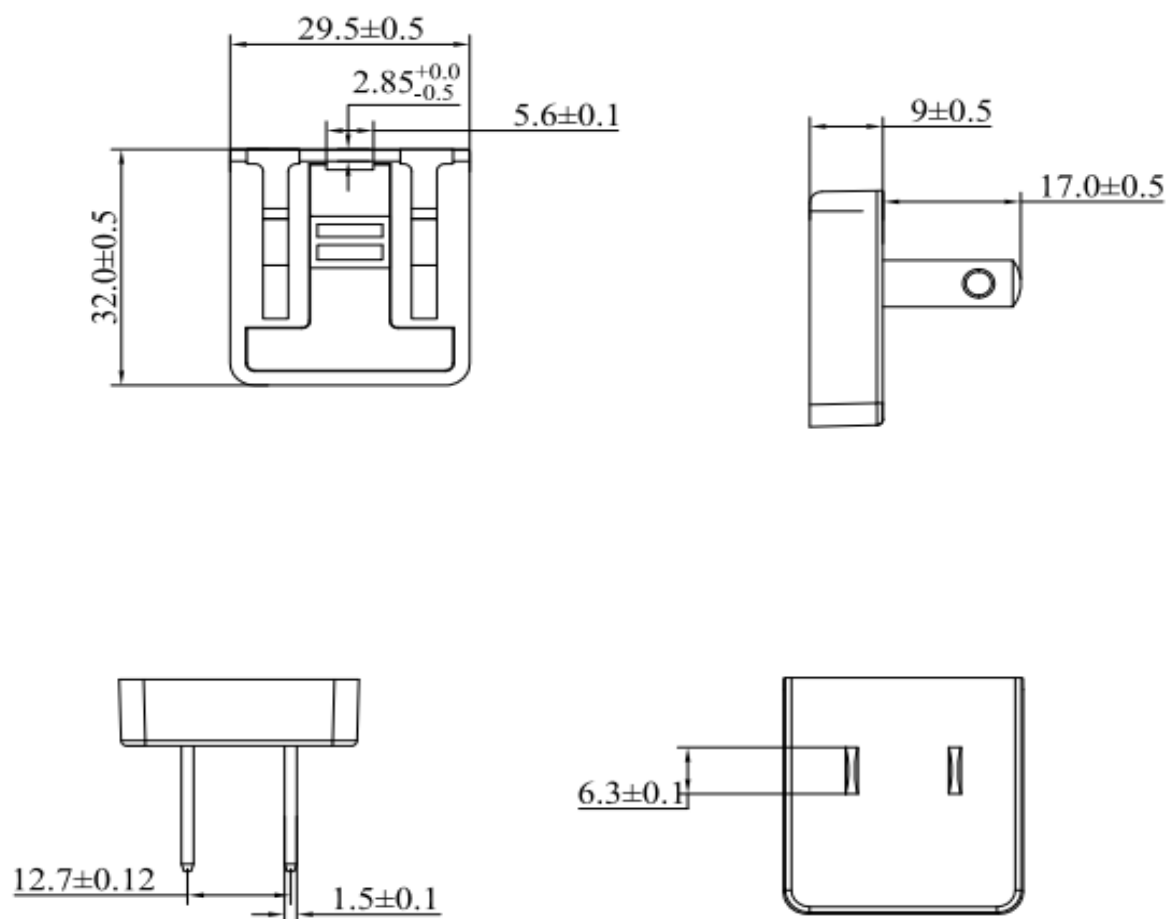

KT1001US

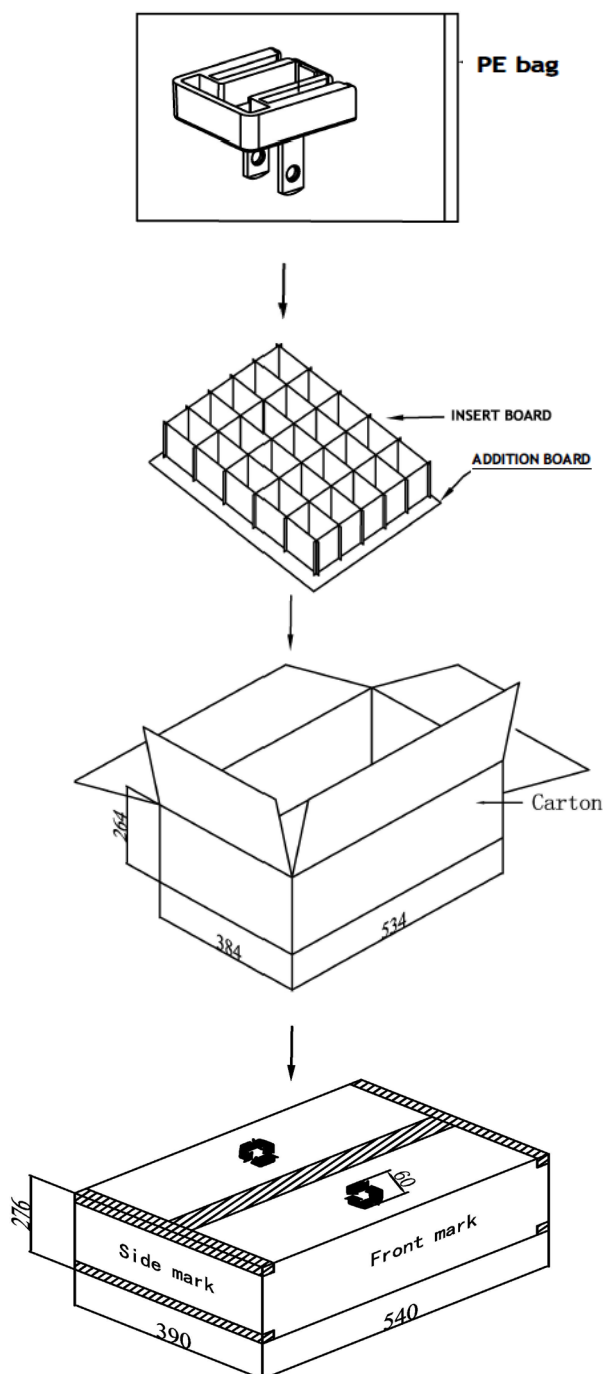

Technical Requirement:

1. Carton: 2 layers wall, 6mm thickness.
Outline dimension: 540mm x 390mm x 276mm
2. Additional board:
3 mm thickness
3 pieces per carton.
3. Humidity protector:
Each plug packed in a small PE bag.
All plugs packed in a big PE bag with an outer carton.
4. Quantity:
2 layers per carton.
200 pes. per layer.
400 pes. per carton.
5. Weight:
Each carton approx. 5.6 kg gross.
Each carton approx. 3.4 kg net.

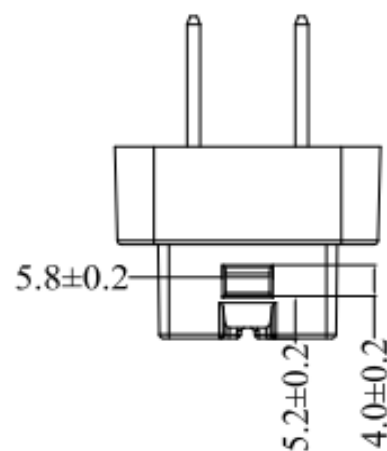
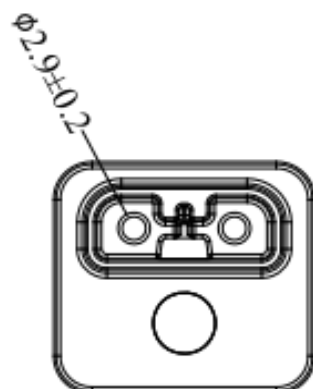
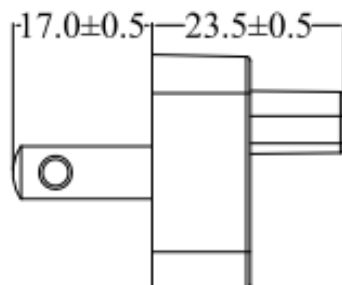
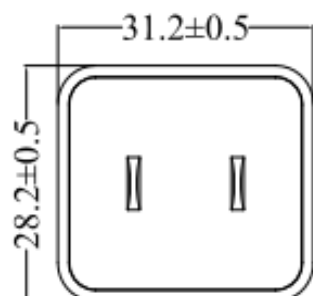

KT1002US

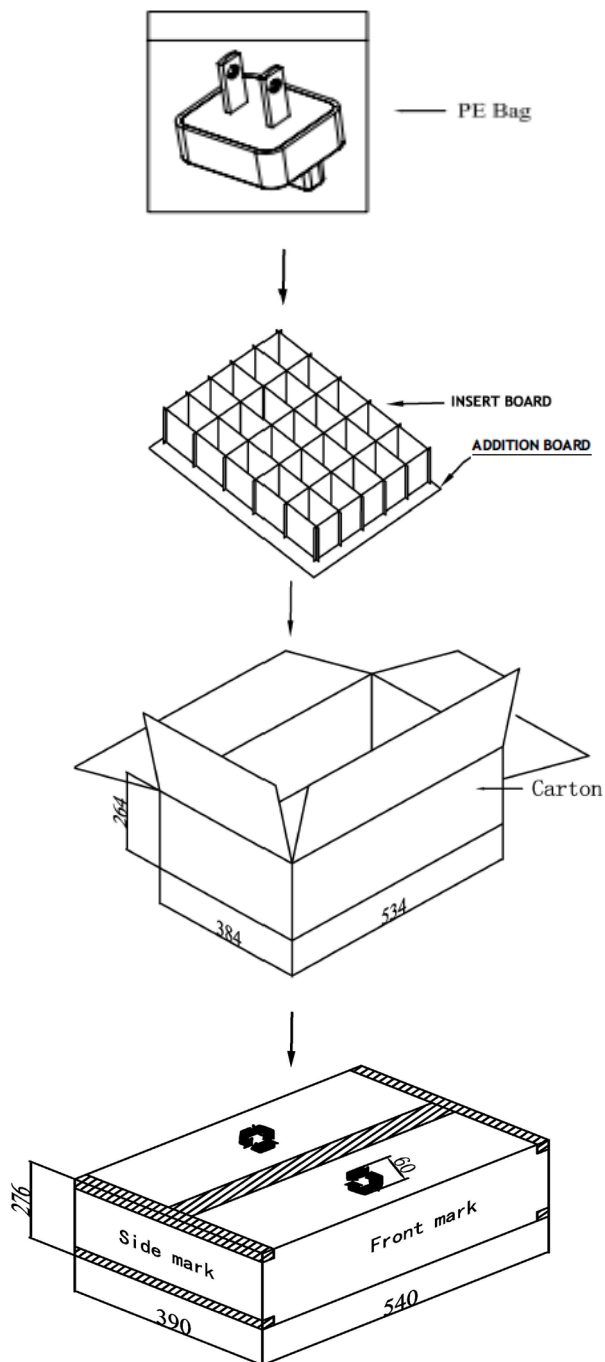

Technical Requirement:

1. Carton: 2 layers wall, 6mm thickness.
Outline dimension: 540mm x 390mm x 276mm
2. Additional board:
3 mm thickness
3 pieces per carton.
3. Humidity protector:
Each plug packed in a small PE bag.
All plugs packed in a big PE bag with an outer carton.
4. Quantity:
2 layers per carton.
200 pes. per layer.
400 pes. per carton.
5. Weight:
Each carton approx. 7.2 kg gross.
Each carton approx. 5.2 kg net.

ORDERING INFORMATION

Model Number	Description	Applicable Area
KT1001AU	AU Plug (SLE06, SLE12, SLE18, SLE24, SLE36N, and SLE60)	Australia
KT1001CH	CH Plug (SLE06, SLE12, SLE18, SLE24, SLE36N, and SLE60)	China
KT1001EU	EU Plug (SLE06, SLE12, SLE18, SLE24, SLE36N, and SLE60)	Europe
KT1001UK	UK Plug (SLE06, SLE12, SLE18, SLE24, SLE36N, and SLE60)	United Kingdom
KT1001US	US Plug (SLE06, SLE12, SLE18, SLE24, SLE36N, and SLE60)	United States
KT1002AU	AU Plug (SLE33 and SLE36X)	Australia
KT1002CH	CH Plug (SLE33 and SLE36X)	China
KT1002EU	EU Plug (SLE33 and SLE36X)	Europe
KT1002UK	UK Plug (SLE33 and SLE36X)	United Kingdom
KT1002US	US Plug (SLE33 and SLE36X)	United States

CARTON LABEL

Side Mark:

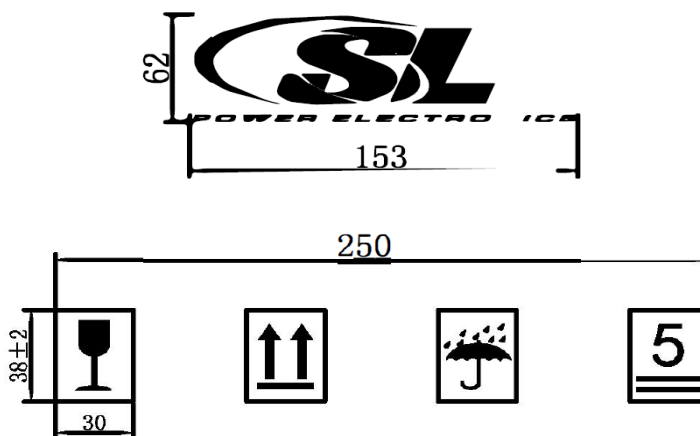

Front Mark:



MODEL No: _____ DATE CODE: _____
 DESCRIPTION: _____ S/N: _____ TO _____
 ORDER No: _____ QTY: _____
 VOLUME: 54.0x39.0x27.6(CM) WEIGHT: _____

SL Power Electronics Co.,Ltd

Notes:

1. Words: SL Electronics Co.,Ltd. is Arial, 20mm high; Other words is Arial, 13mm high
2. Color: Recycle lagoon 60mm high, center position; Words & lagoon is black.



For international contact information,
visit advancedenergy.com.

powersales@aei.com (Sales Support)
productsupport.ep@aei.com (Technical Support)
+1 888 412 7832

ABOUT ADVANCED ENERGY

Advanced Energy (AE) has devoted more than four decades to perfecting power for its global customers. AE designs and manufactures highly engineered, precision power conversion, measurement and control solutions for mission-critical applications and processes.

Our products enable customer innovation in complex applications for a wide range of industries including semiconductor equipment, industrial, manufacturing, telecommunications, data center computing, and medical. With deep applications know-how and responsive service and support across the globe, we build collaborative partnerships to meet rapid technological developments, propel growth for our customers, and innovate the future of power.

PRECISION | POWER | PERFORMANCE | TRUST

Specifications are subject to change without notice. Not responsible for errors or omissions. ©2025 Advanced Energy Industries, Inc. All rights reserved. Advanced Energy®, and AE® are U.S. trademarks of Advanced Energy Industries, Inc.